

### Flying Oval post with distance beams

**Item.no:**  
**Midi** IS-9426  
**Maxi** IS-9427

**Complete with:**

- |                                |                     |                     |
|--------------------------------|---------------------|---------------------|
| 1 Oval post, Base 760          | <b>Midi IS-9426</b> | <b>Maxi IS-9427</b> |
| 1 Oval post, Center 750/850    | IS-OP-760-BP        | IS-OP-760-BP        |
| 1 Oval post, Top 755/855       | IS-OP-750-EP        | IS-OP-850-EP        |
| 1 Foot                         | IS-OP-755-TP        | IS-OP-855-TP        |
| 2 Distance beam, 165 mm        | IS-03-OF            | IS-03-OF            |
| 1 Corner trim kit with cut out | IS-165-DP           | IS-165-DP           |
|                                | IS-CF-82-CTLR       | IS-CF-83-CTLR       |



### Accessories



**Literature holder**  
Item IS-80-LH01



**Media screen holder**  
Item IS-80-TM04



**iPad holder**  
Item IS-80-TM05



**Keyboard plinth**  
Item IS-CO-KP



**Table attachment**  
Item IS-CO-ST



**1** Replace the old corner trims with the new set included in your Flying Oval post module.



**2** Attach the two distance beams in the cut outs of the new corner trims.

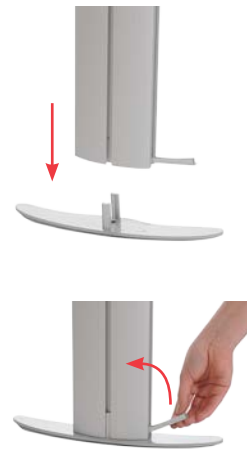

**3** Attach the foot in the base section of oval post lock in place.



**4** Start to attach the base section with the distance beam.



**5** Mount the center section in top of the base and end with the top post section, locking it into place with the top distance beam.